

# OFFICE SUITES FOR LEASE



1110 N Florida Ave, Tampa, FL 33602



# 1110 N Florida Ave, Tampa, FL 33602



- 900 SF
- \$34 PSF, \$2550/mo. Full Service
- 24-hour access
- On-site parking
- Rooftop deck access
- Short-term, one-page lease options
- Shared kitchen, conference & gym with shower
- Excellent access to I-275, I-4 and Crosstown
- Centrally located: walk to courthouses, restaurants, The Riverwalk & Armature Works



**Abbey Ahern**

Principal, Brokerage

813.416.7155

Abbey@DohringAhern.com

# FLOOR PLAN

## Suite 205 & 206 + Open Area 900 SF +/-

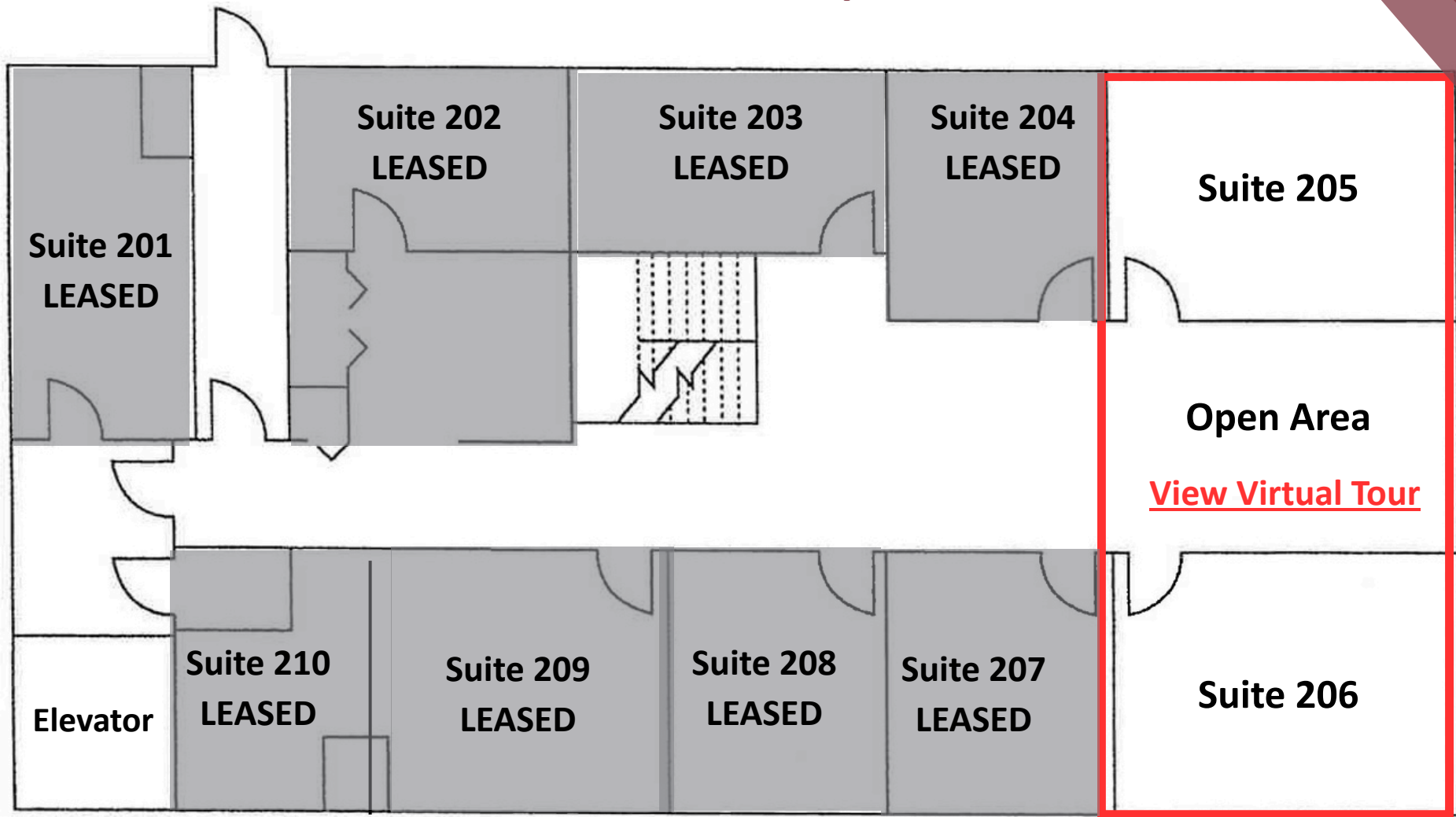

\*NOT TO SCALE

1110 N Florida Ave, Tampa, FL 33602

**Abbey Ahern**

Principal, Brokerage

813.416.7155

Abbey@DohringAhern.com





# MAP

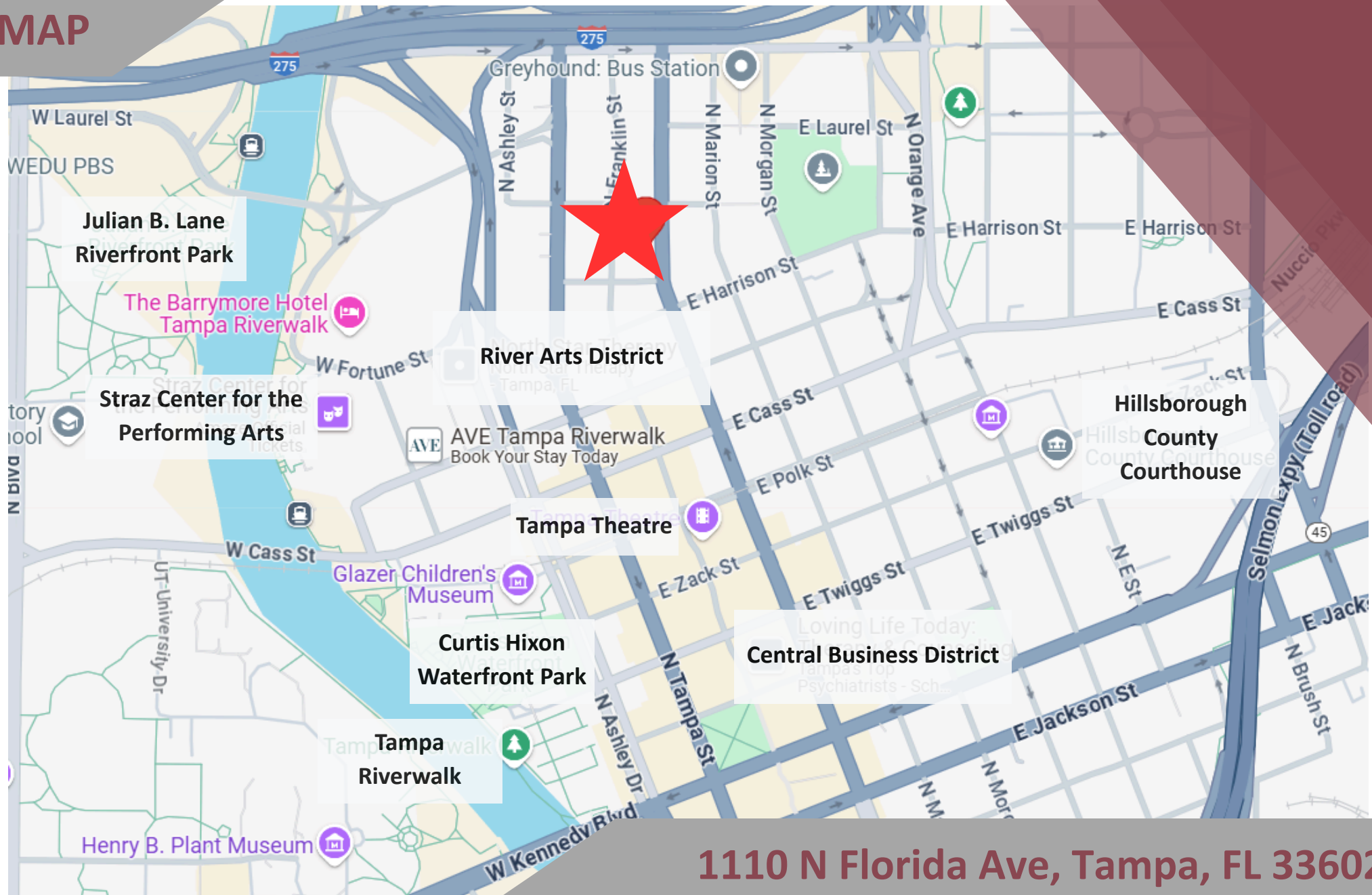

1110 N Florida Ave, Tampa, FL 33602

\*NOT TO SCALE

**Abbey Ahern**

Principal, Brokerage

813.416.7155

Abbey@DohringAhern.com



1110 N Florida Ave, Tampa, FL 33602

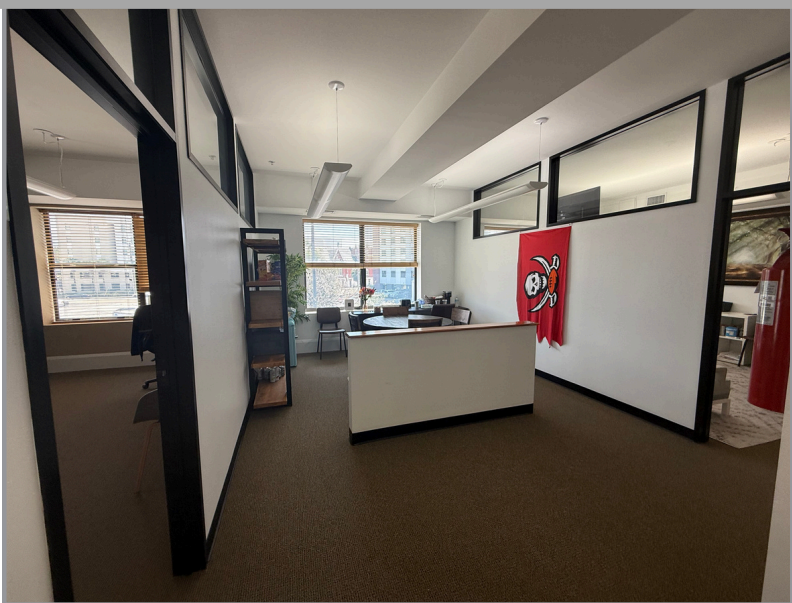

**Abbey Ahern**

Principal, Brokerage

813.416.7155

[Abbey@DohringAhern.com](mailto:Abbey@DohringAhern.com)

