

OFFICE SPACE FOR LEASE



4017 W. Martin Luther King Jr. Blvd., Tampa, FL 33614

4017 W. Martin Luther King Jr. Blvd., Tampa, FL 33614



- Ste. 103: 1,200 SF
 - Open work space and 5 private offices
- \$26.00 PSF Modified Gross
- 3.91/1,000 parking ratio (84 spaces)
- Fully gated secure facility with fiber located in a non-evacuation zone with generator
- Located in a HubZone & Industrial General Zoned
- Great amenities including breakroom and terrace
- Conveniently located in the Westshore submarket with easy access to I-275, and Veterans Expressway
- Close proximity to Rays Stadium, Buccaneers Stadium, Tampa Int'l Airport, International Plaza & St. Joseph's Hospital



Abbey Ahern

Principal, Brokerage

813.223.9111

Abbey@DohringAhern.com

Floorplan

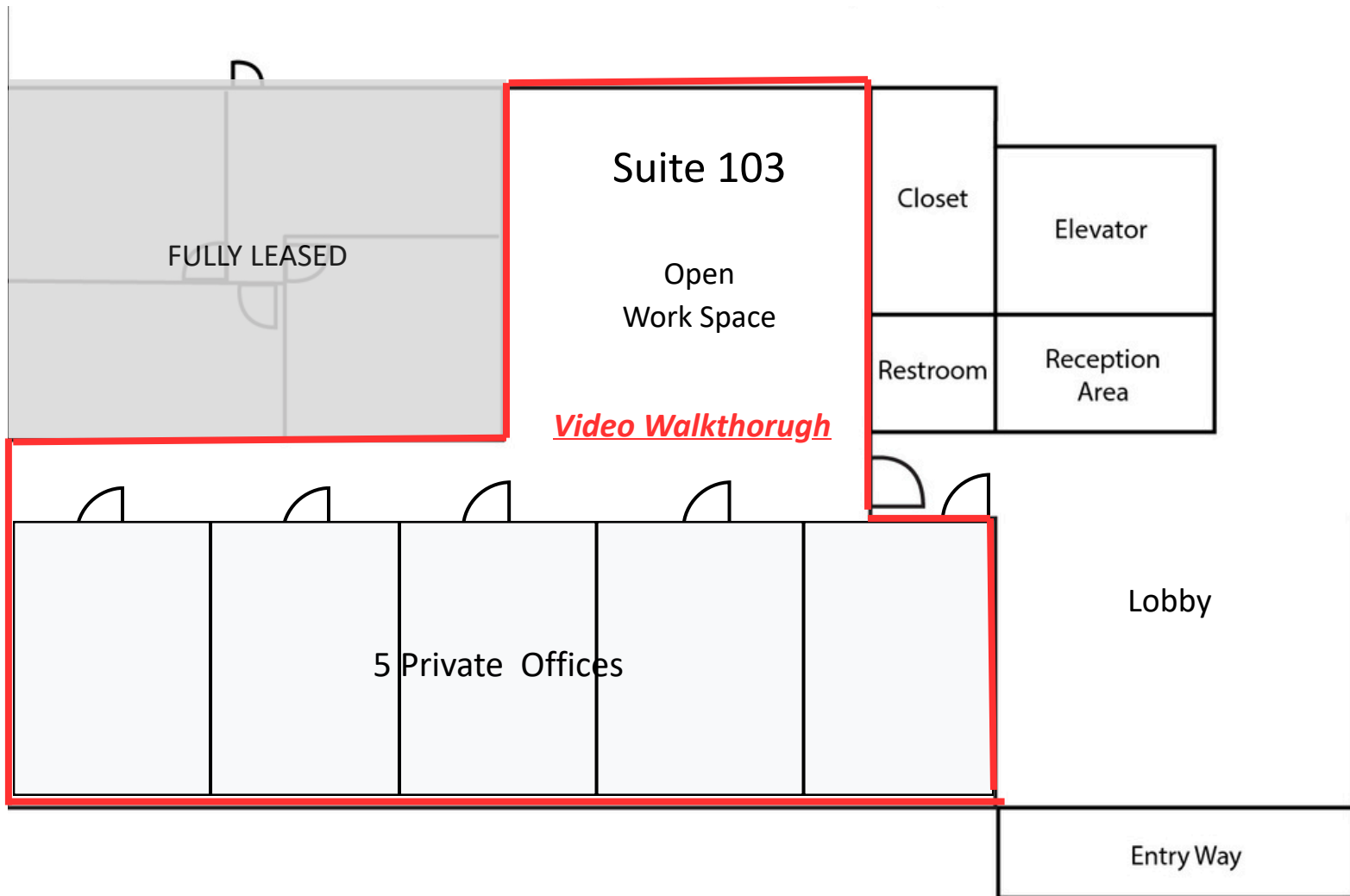

*NOT TO SCALE

4017 W. Martin Luther King Jr. Blvd., Tampa, FL 33614

Abbey Ahern

Principal, Brokerage

813.223.9111

Abbey@DohringAhern.com



Suite 103

Private offices (5) & open workspace



Abbey Ahern

Principal, Brokerage

813.223.9111

Abbey@DohringAhern.com

Lobby, Parking, 2nd floor terrace, and Security Gate



Abbey Ahern

Principal, Brokerage

813.223.9111

Abbey@DohringAhern.com



MAP



4017 W. Martin Luther King Jr. Blvd., Tampa, FL 33614

Abbey Ahern

Principal, Brokerage

813.223.9111

Abbey@DohringAhern.com

